

HIGH PRESSURE MASTER SHUT-OFF VALVE

Information for customers and partners

High Pressure Master Shut-Off Valve (REGO USA) :

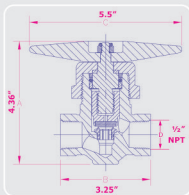

Make	: REGO USA
Type	: High Pressure Valve
Size	: 1/2"
End Connection	: 1/2" NPT Female Thread
Media	: Air Gases & Vapours (Nitrogen, Oxygen, Argon, Hydrogen etc.)
Temperature	: -40°F to +165°F
Pressure	: 4200 PSI
Application	: The High Pressure brass valves are used on cylinder filling panels, tube trailers and other high pressure manifold and piping systems. The high pressure valve series exhibits a very low operating torque under pressure for ease of manual operation.
Cleaning	: Cleaned and degreased for Oxygen Service
Materials	: Body, Bonnet, Stem and Seat Retainer, Steam Seal Retaining Ring and Washer : Brass Steam O-Ring : Viton Hand Wheel Washer : PTFE

Regd. Office : A-36, Ghanshyam Nagar Society No.2,
GIDC Road, Manjalpur, Vadodara - 390 011.
Gujarat, INDIA.

Contact Details :

Phone : +91 265 2662236 / 2662288
Fax : +91 265 2662047
Website : www.cryogas-equipment.com

Contact Person :

Mr. Nehal Sheth (Marketing Officer - Valves Division)
Mobile : +91 95740 04429
E-mail : sales@cryogas-equipment.com
Skype : nehalsheth11